

# LOT SPLIT

OF

A PORTION OF THE NORTHWEST QUARTER OF SECTION 16, TOWNSHIP 6 NORTH,  
RANGE 4 EAST OF THE GILA AND SALT RIVER BASE AND MERIDIAN,  
TOWN OF CAVE CREEK, MARICOPA COUNTY, ARIZONA.

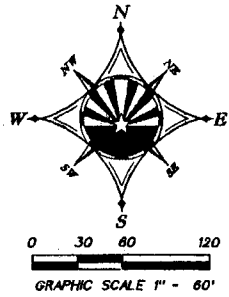

## VICINITY MAP

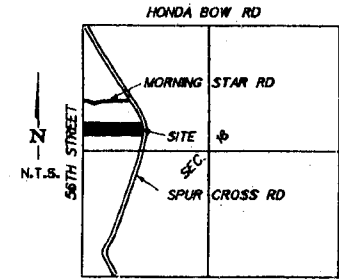

## SITE DATA

TOTAL	203,688 S.F.
LOT 1	87,120 S.F.
LOT 2	116,568 S.F.
EXISTING STRUCTURE	4,665 S.F.
ZONING	DR-70
A.P.N.	211-82-112A

## LEGEND

- FOUND MONUMENT (TYPE SHOWN)
- PROPERTY LINE
- SET MONUMENT (1/2" REBAR W/ CAP 26404)
- (M) MEASURED
- (R) RECORDED
- B.S. BUILDING SET-BACK

## SURVEYOR'S CERTIFICATION

I, JAMES A. LOFTIS, HEREBY CERTIFY THAT THE SURVEY PLATTED HEREON WAS MADE UNDER MY SUPERVISION DURING THE MONTH OF APR., 2006.



CNTR.  
SEC. 16  
1/2" RB

1692.71  
2629.89

## APPROVED

THIS IS TO CERTIFY THAT THE LOT SPLIT SHOWN THEREON WAS APPROVED BY THE TOWN OF CAVE CREEK ON THIS 13<sup>TH</sup> DAY OF ~~APRIL~~ APRIL, 2006.

BY Jan E. Goodrich DATE 6/19/06  
ZONING ADMINISTRATOR

BY Christa Hammer DATE 12/19/06  
TOWN CLERK

## NOTES

- THIS SURVEY WAS DONE WITHOUT THE BENEFIT OF A TITLE REPORT AND IS SUBJECT TO ALL EASEMENTS OF RECORD.
- BEARINGS ARE BASED ON NAD 83 DATUM.
- THIS SURVEY IS NOT INTENDED FOR ENGINEERING DESIGN OR LAYOUT.
- SURVEY IS VALID ONLY IF PRINT HAS ORIGINAL SEAL AND SIGNATURE OF SURVEYOR.
- ANY INFORMATION, OTHER THAN SURVEY RELATED, DEPICTED ON THIS MAP ARE INFORMATIONAL ONLY. NO CERTIFICATION IS GIVEN AS TO ITS ACCURACY. THIS WOULD INCLUDE, BUT NOT BE LIMITED TO, ALL MATTERS EASILY VERIFIED VIA PUBLIC RECORDS.

## REFERENCES

BOOK 388 OF MAPS, PAGE 27, M.C.R.  
BOOK 530 OF MAPS, PAGE 30, M.C.R.  
BOOK 711 OF MAPS, PAGE 20, M.C.R.  
WARANTY DEED INST. \*01-0832080

## OWNER

DOUG MONROE

BOOK 878 PAGE 9  
OFFICIAL RECORDS OF  
MARICOPA COUNTY RECORDER  
HELEN PURCELL  
2006 - 1454732

11/02/2006 09:44 AM

**CONSULTING LAND SURVEYORS**  
37417 N. CAVE CREEK ROAD CAVE CREEK, AZ 85331  
PHONE (480) 994-0545 FAX (480) 994-9997

JOB NO  
060303